

FORM No. 1.

Courses & Distances  
up the river  
1<sup>st</sup> N 87 E 50 perches  
2<sup>d</sup> S 85 E 90  
3. N 82 E 50  
4. N 75 E 81  
5. East 32  
Total 303 p<sup>s</sup>

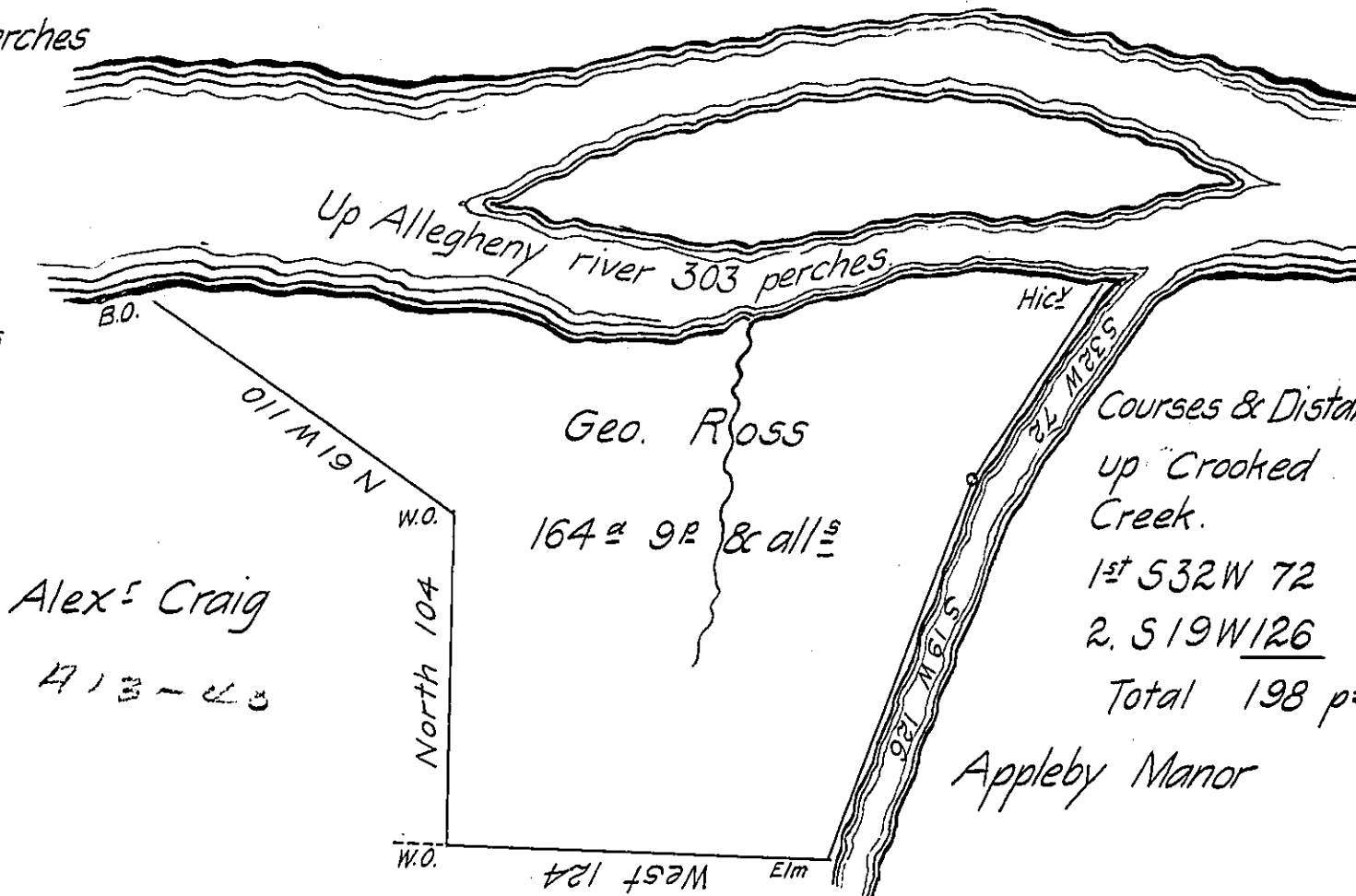

Courses & Distance  
up Crooked  
Creek.  
1<sup>st</sup> S 32 W 72  
2. S 19 W 126  
Total 198 p<sup>s</sup>

John Morrison Now Jo<sup>s</sup> Claypole

The above is a draught of a Tract of Land Situate in Allegheny Township Armstrong County adjoining Land of Alexander Craig the Allegheny river and Crooked Creek Containing One hundred and Sixty four Acres and nine perches and allowance of Six ~~p~~ Cent for Roads &c. Surveyed the 24<sup>th</sup> day of March A<sup>d</sup> 1830 in pursuance of a Warrant Granted to Geo. Ross dated the 26<sup>th</sup> day of January A<sup>d</sup> 1830 including his actual Settlement & Improvement. ~~p~~ Robert Richards a former Deputy Surveyor taken from his Draught now in my possession which I have examined and find Correct. Certified this 6<sup>th</sup> day of March A.D. 1838.

J.E. Meredith D.S.

To Jn<sup>o</sup> Taylor Esqr.  
Surveyor General }

IN TESTIMONY that the above is a copy of the original remaining on file in the Department of Internal Affairs of Pennsylvania, made conformably to an Act of Assembly approved the 16th day of February, 1833, I have hereunto set my Hand and caused the Seal of said Department to be affixed at Harrisburg, this tenth day of October 1906.

*Isaac P. ...*  
Secretary of Internal Affairs